

**LB2000 EX - LB2500 EX (M)  
LB3000 EX (M, MY)**

**OKUMA**

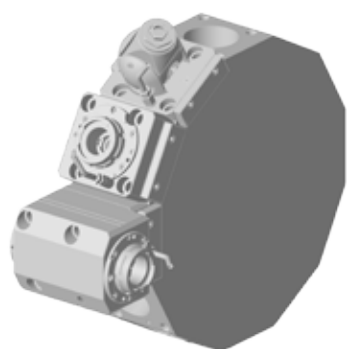

**STATIC TOOLS**

1) O.D. Cutting holder

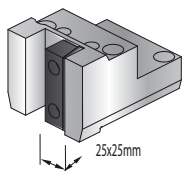

2) I.D. Cutting holder

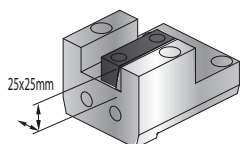

3) Cut off holder

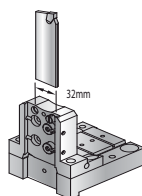

4) Boring Bar holder

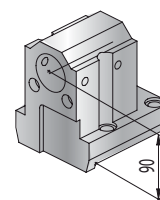

5) Boring Bar holder refr. combi

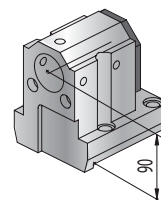

6) Double O.D. holder

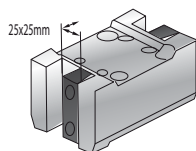

7) Double I.D. holder

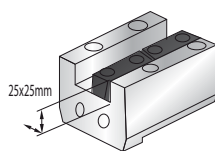

8) Double boring bar holder

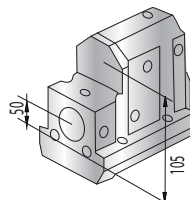

9) Double boring bar IC refr. combi

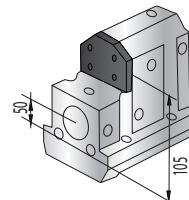

10) Boring bar sleeve

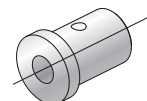

**Technical Data / Dati Tecnici**

**Code  
Codice**

**1) O.D. CUTTING HOLDER 25X25mm**  
1) Portautensile per esterni 25x25mm

AOK.EX3.OD25

**2) I.D. CUTTING HOLDER 25X25mm**  
2) Portautensile per interni 25x25mm

AOK.EX3.ID25

**3) CUT OFF HOLDER 32mm**  
3) Portalama 32mm

AOK.EX3.CO32

**4) BORING BAR HOLDER 40mm**  
4) Portabareno 40mm

AOK.EX3.BB40

**5) BORING BAR IC REFR. COMBI 40mm**  
5) Portabareno refrigerato combi 40 mm

AOK.EX3.BB40.C

**Technical Data / Dati Tecnici**

**Code  
Codice**

**6) DOUBLE O.D. HOLDER 25x25mm**  
6) Portautensile doppio per esterni 25x25mm

AOK.EX3.OD25.2

**7) DOUBLE I.D. HOLDER 25x25mm**  
7) Portautensile doppio per interni 25x25mm

AOK.EX3.ID25.2

**8) DOUBLE BORING BAR HOLDER 40mm**  
8) Portabareno doppio 40mm

AOK.EX3.BB40.2

**9) DOUBLE BORING BAR IC REFR COMBI 40mm**  
9) Portabareno doppio refrigerato combi 40mm

AOK.EX3.BB40.2C

**10) BORING BAR SLEEVE**  
10) Bussole di riduzione

AOK.EX3.RDX

## LB2000 EX - LB2500 EX (M) LB3000 EX (M, MY)

### LIVE TOOLS

1A) Axial MA-3,5

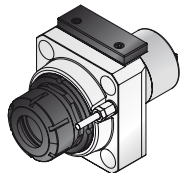

1B) Axial MA-3,5 C 70 Bar

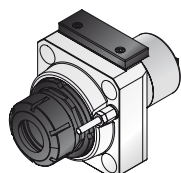

2A) Radial M90-3,5

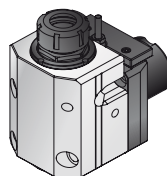

2B) Radial M90-3,5 C 70 Bar

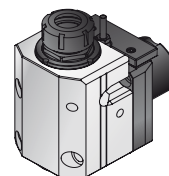

3) Radial M90-3,5 2U

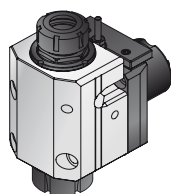

4) Adjustable MCU-1,5

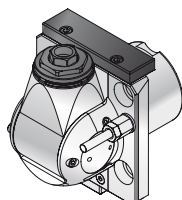

#### Technical Data / Dati Tecnici

#### Code Codice

#### 1A) AXIAL MA-3,5

1A) Assiale MA-3,5

AOK.EX3.0100

#### 1B) AXIAL MA-3,5 C 70 Bar

1B) Assiale MA-3,5 C 70 Bar

AOK.EX3.010C

#### 2A) RADIAL M90-3,5

2A) Radiale M90-3,5

AOK.EX3.0200

#### Technical Data / Dati Tecnici

#### Code Codice

#### 2B) RADIAL M90-3,5 C 70 Bar

2B) Radiale M90- 3,5 C 70 Bar

AOK.EX3.020C

#### 3) RADIAL M90-3,5 2U ER32/ER32

3) Radiale M90- 3,5 2U ER32/ER32

AOK.EX3.0300

#### 4) ADJUSTABLE MCU-1,5

4) Orientabile MCU-1,5

AOK.EX3.0500



 **SmartChange**

Ref. Pg 31 / Rif. Pag 31

## LB4000 EX (M, MY)

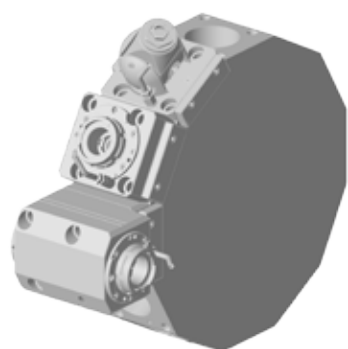

## STATIC TOOLS

1) OD Cutting holder

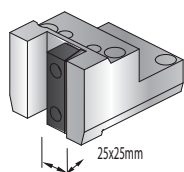

2) ID Cutting holder

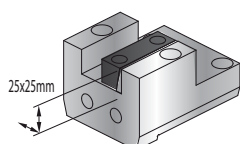

3) Cut-off holder

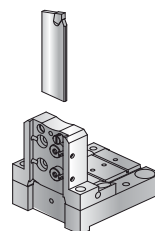

4) Boring bar holder

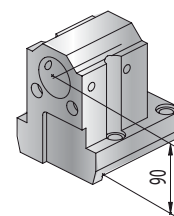

5) Boring bar IC Refr. Combi

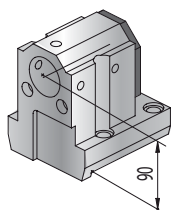

6) Boring bar sleeve

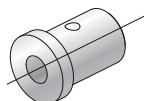

## Technical Data / Dati Tecnici

Code  
Codice

**1) O.D. CUTTING HOLDER 25X25mm**  
1) Portautensile per esterni 25x25mm

AOK.EX4.OD25

**2) I.D. CUTTING HOLDER 25X25mm**  
2) Portautensile per interni 25x25mm

AOK.EX4.ID25

**3) CUT OFF HOLDER 32mm**  
3) Portalama 32mm

AOK.EX4.CO32

## Technical Data / Dati Tecnici

Code  
Codice

**4) BORING BAR HOLDER 40mm**  
4) Portabareno 40mm

AOK.EX4.BB40

**5) BORING BAR IC REFR. COMBI 40 mm**  
5) Portabareno refrigerato combi 40 mm

AOK.EX4.BB40.C

**6) BORING BAR SLEEVE**  
6) Bussole di riduzione

AOK.EX4.RDX

### LIVE TOOLS

1A) Axial MA-4,5

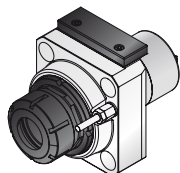

1B) Axial MA-4,5 C 70 Bar

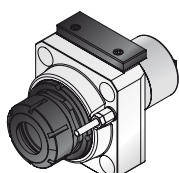

2A) Radial M90-4,5

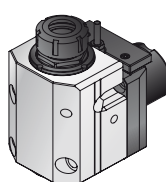

2B) Radial M90-4,5 C 70 Bar

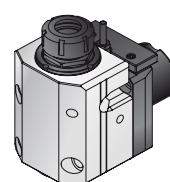

3) Adjustable MCU-2,5

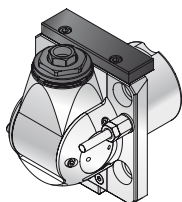

#### Technical Data / Dati Tecnici

#### Code Codice

**1A) AXIAL MA-4,5**

1A) Assiale MA-4,5

AOK.EX4.0100

**1B) AXIAL MA-4,5 C 70 Bar**

1B) Assiale MA-4,5 C 70 Bar

AOK.EX4.010C

**2A) RADIAL M90-4,5**

2A) Radiale M90-4,5

AOK.EX4.0200

#### Technical Data / Dati Tecnici

#### Code Codice

**2B) RADIAL M90-4,5 C 70 Bar**

2B) Radiale M90- 4,5 C 70 Bar

AOK.EX4.020C

**3) ADJUSTABLE MCU-2,5 ER 25**

3) Orientabile MCU-2,5 ER 25

AOK.EX4.0500

## LT2000 EX (M, MY, MYW)

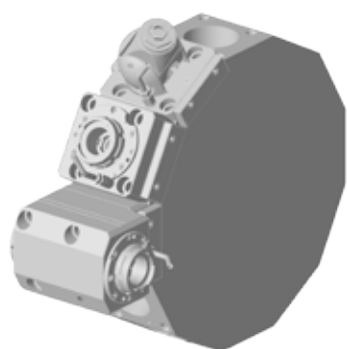

## STATIC TOOLS

1) OD Cutting holder

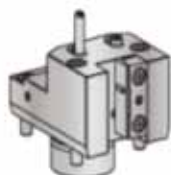

2) Double OD Cutting holder



3) ID Cutting holder



4) Cut off holder

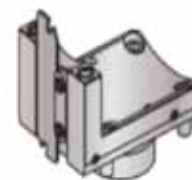

5) Boring bar holder



6) Boring bar IC holder

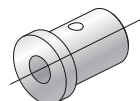

7) Boring bar sleeve

**Technical Data / Dati Tecnici****Code  
Codice**

**1) O.D. CUTTING HOLDER 20X20mm**  
1) Portautensile per esterni 20x20mm

AOK.L20.OD20

**2) DOUBLE O.D. CUTTING HOLDER 20X20mm**  
2) Portautensile per esterni doppio 20x20mm

AOK.L20.OD20.2

**3) I.D. CUTTING HOLDER 20X20mm**  
3) Portautensile per interni 20x20mm

AOK.L20.ID20

**4) CUT OFF HOLDER 26mm**  
4) Portalama 26mm

AOK.L20.CO26

**Technical Data / Dati Tecnici****Code  
Codice**

**5) BORING BAR HOLDER 32mm**  
5) Portabareno 32mm

AOK.L20.BB32

**6) BORING BAR IC HOLDER COMBI 32 mm**  
6) Portabareno doppio refrigerato combi 32 mm

AOK.L20.BB32.C

**7) BORING BAR SLEEVE**  
7) Bussole di riduzione

AOK.L20.RDX

### LIVE TOOLS

1A) Axial MA-2,5

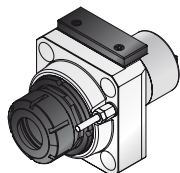

1B) Axial MA-2,5 C 70 Bar

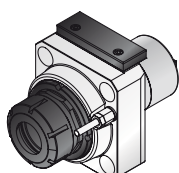

2A) Radial M90-2,5

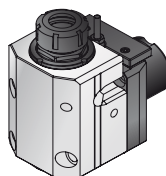

2B) Radial M90-2,5 C 70 Bar

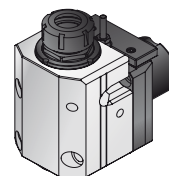

#### Technical Data / Dati Tecnici

#### Code Codice

**1A) AXIAL MA-2,5**

1A) Assiale MA-2,5

AOK.L20.0100

**1B) AXIAL MA-2,5 C 70 Bar**

1B) Assiale MA-2,5 C 70 Bar

AOK.L20.010C

#### Technical Data / Dati Tecnici

#### Code Codice

**2A) RADIAL M90-2,5**

2A) Radiale M90- 2,5

AOK.L20.0200

**2B) RADIAL M90-2,5 C 70 Bar**

2B) Radiale M90- 2,5 C 70 Bar

AOK.L20.020C



 **SmartChange**

Ref. Pg 31 / Rif. Pag 31

VDI 30 - LB 10M / LB 10II M  
LB 200M / LT 200M / GENOS L Series

OKUMA

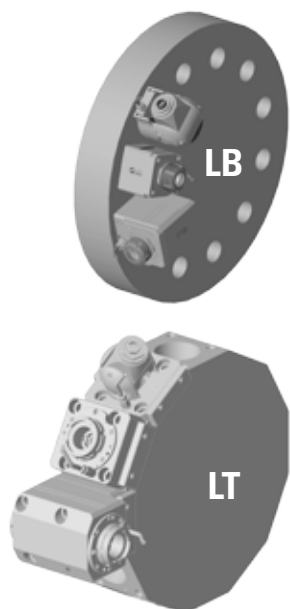

STATIC TOOLS

1) O.D. Cutting holder

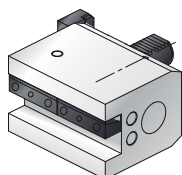

2) I.D. Cutting holder

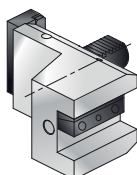

3) Double I.D. Cutting holder

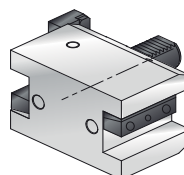

4) Cut-off holder

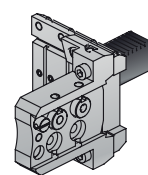

5) Offset boring bar holder RH

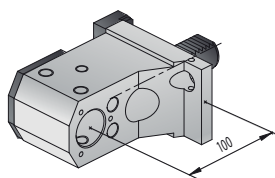

6) Offset boring bar holder LH

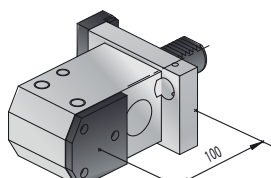

7) Double boring bar holder

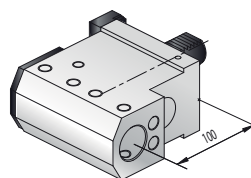

8) Boring bar sleeve

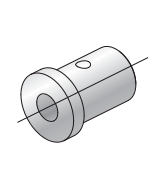

Technical Data / Dati Tecnici

Code  
Codice

1) O.D. CUTTING HOLDER 20X20mm  
1) Portautensile per esterni 20x20mm

AOK.LT3.OD20

2) I.D. CUTTING HOLDER 20X20mm  
2) Portautensile per interni 20x20mm

AOK.LT3.ID20

3) DOUBLE I.D. CUTTING HOLDER 20X20mm  
3) Portautensile per interni doppio 20x20mm

AOK.LT3.ID20.2

4) CUT OFF HOLDER 26mm  
4) Portalama 26mm

AOK.LT3.CO26

Technical Data / Dati Tecnici

Code  
Codice

5) OFFSET BORING BAR HOLDER RH 32 mm  
5) Portabareno arretrato Dx 32 mm

AOK.LT3.BB32.AR

6) OFFSET BORING BAR HOLDER LH 32 mm  
6) Portabareno arretrato Sx 32 mm

AOK.LT3.BB32.AL

7) DOUBLE BORING BAR HOLDER COMBI 32 mm  
7) Portabareno doppio combi 32 mm

AOK.LT3.BB32.C2

8) BORING BAR SLEEVE  
8) Bussole di riduzione

AOK.LT3.RDX

## VDI 30 - LB 10M / LB 10II M LB 200M / LT 200M / GENOS L Series

### LIVE TOOLS

1A) Axial MA-2,5

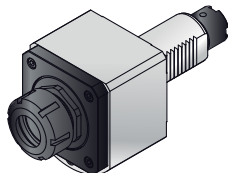

1B) Axial MA-2,5 C 70 Bar

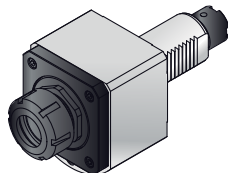

2A) Radial M90-2,5

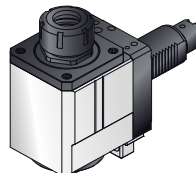

2B) Radial M90-2,5 C 70 Bar

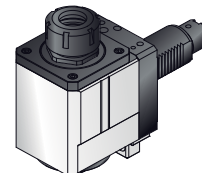

3) Adjustable MCU-1,5

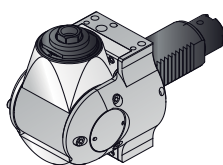

#### Technical Data / Dati Tecnici

#### Code Codice

**1A) AXIAL MA-2,5**

1A) Assiale MA-2,5

AOK.LT3.0100

**1B) AXIAL MA-2,5 C 70 Bar**

1B) Assiale MA-2,5 C 70 Bar

AOK.LT3.010C

**2A) RADIAL M90-2,5**

2A) Radiale M90-2,5

AOK.LT3.0200

#### Technical Data / Dati Tecnici

#### Code Codice

**2B) RADIAL M90-2,5 C 70 Bar**

2B) Radiale M90-2,5 C 70 Bar

AOK.LT3.020C

**3) ADJUSTABLE MCU-1,5**

3) Orientabile MCU-1,5

AOK.LT3.0500



VDI 40 - LR 15M / LB 15M / LU 15M / LB 300  
 LT1 5MY / LT 300 / LTV 300M  
 VDI 40 - LR 25M / LB 25M / LU 25M / LB 400  
 LT 400 / LTV 400M

OKUMA

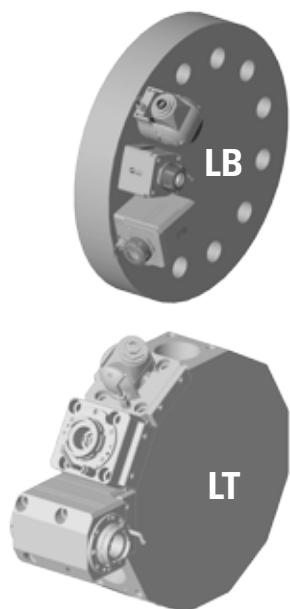

## STATIC TOOLS

1) O.D. Cutting holder

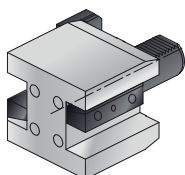

2) I.D. Cutting holder

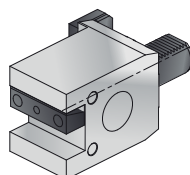

3) Cut-off holder

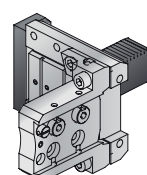

4) Offset boring bar holder RH

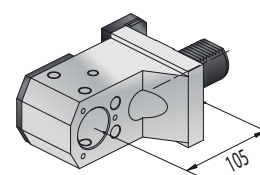

5) Offset boring bar holder LH

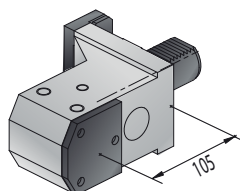

6) Double boring bar holder combi

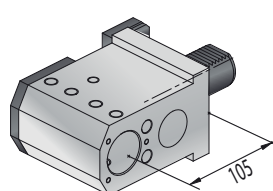

7) Boring bar sleeve

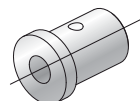

## Technical Data / Dati Tecnici

Code  
Codice

**1) O.D. CUTTING HOLDER 25X25 mm**  
 1) Portautensile per esterni 25x25 mm

AOK.LT4.OD25

**2) I.D. CUTTING HOLDER 25X25 mm**  
 2) Portautensile per interni 25x25 mm

AOK.LT4.ID25

**3) CUT OFF HOLDER 32 mm**  
 3) Portalama 32 mm

AOK.LT4.CO32

**4) OFFSET BORING BAR HOLDER RH 40 mm**  
 4) Portabareno arretrato Dx 40 mm

AOK.LT4.BB40.AR

## Technical Data / Dati Tecnici

Code  
Codice

**5) OFFSET BORING BAR HOLDER LH 40 mm**  
 5) Portabareno arretrato Sx 40 mm

AOK.LT4.BB40.AL

**6) DOUBLE BORING BAR HOLDER COMBI 40 mm**  
 6) Portabareno doppio combi 40 mm

AOK.LT4.BB40.C2

**7) BORING BAR SLEEVE**  
 7) Bussola di riduzione

AOK.LT4.RDX

### LIVE TOOLS

1A) Axial MA-3,5

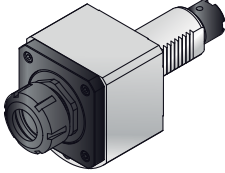

1B) Axial MA-3,5 C 70 Bar

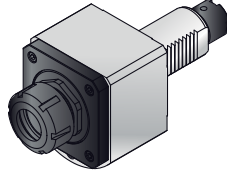

2A) Axial MA-3,5 R Front

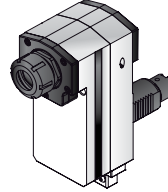

2B) Axial MA-3,5 R Back

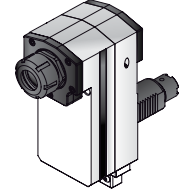

3) Axial MA 3,5 R 2U

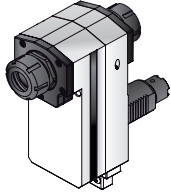

4A) Radial M90- 3,5

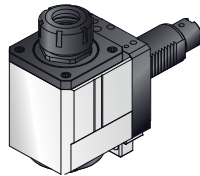

4B) Radial M90- 3,5 C 70 Bar

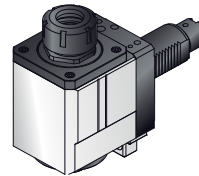

5) Radial Offset M90 3,5 A

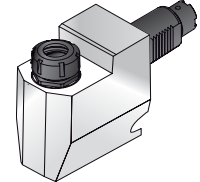

6A) Adjustable MCU 1,5

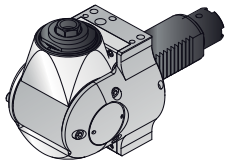

6B) Adjustable MCU 2,5

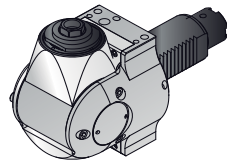

#### Technical Data / Dati Tecnici

#### Code Codice

**1A) AXIAL MA-3,5**

1A) Assiale MA-3,5

AOK.LT4.0100

**1B) AXIAL MA-3,5 C 70 Bar**

1B) Assiale MA-3,5 C 70 Bar

AOK.LT4.010C

**2A) AXIAL MA-3,5 R ER 32 FRONT**

2A) Assiale MA-3,5 R ER 32 Frontale

AOK.LT4.0400

**2B) AXIAL MA-3,5 R ER 32 BACK**

2B) Assiale MA-3,5 R ER 32 Retro

AOK.LT4.0410

**3) AXIAL MA-3,5 R 2U**

3) Assiale MA-3,5 R 2U

AOK.LT4.0420

#### Technical Data / Dati Tecnici

#### Code Codice

**4A) RADIAL M90- 3,5**

4A) Radiale M90 - 3,5

AOK.LT4.0200

**4B) RADIAL M90- 3,5 C 70 Bar**

4B) Radiale M90 - 3,5 C 70 Bar

AOK.LT4.020C

**5) RADIAL OFFSET M90- 3,5 A**

5) Radiale arretrato M90- 3,5 A

AOK.LT4.0700

**6A) ADJUSTABLE MCU-1,5**

6A) Orientabile MCU-1,5

AOK.LT4.0500

**6B) ADJUSTABLE MCU-2,5**

6B) Orientabile MCU-2,5

AOK.LT4.0501



**SmartChange**

Ref. Pg 31 / Rif. Pag 31